

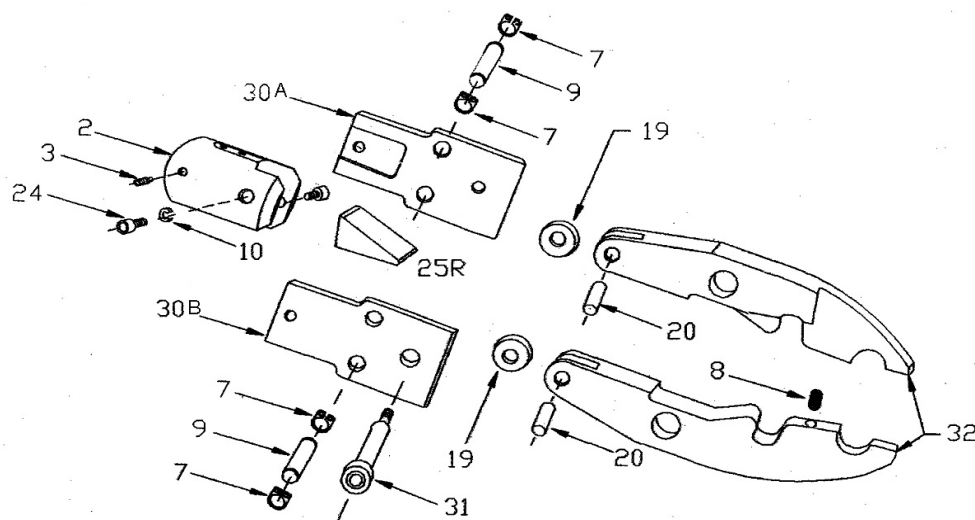

# SA-2000 Jaw and Housing



2	Jaw Housing for A-4 Jaws	4-2A
3	Set Screw	4-3A
7	Snap Ring (4 required)	4-7A
8	Internal Jaw Spring	4-8A
9	Pivot Pin (2 required)	4-9A
10	Lock Washer (4 required)	4-10A
19	Jaw Roller (2 required)	4-19-525-K2
20	Roller Pin (2 required)	4-20A
24	Jaw Assembly Screw (4 required)	4-24A
30A	Side Plate (with threaded hole)	20-20A
30B	Side Plate (with threaded hole)	20-20B
31	Side Plate Pivot Screw	4-24B
32	Replacement Jaws	RSA-2000
25-R	Cam (not included, order separate)	25-R

**Note:** The powerpack using this jaw and housing requires the 25-R Cam. Consult your distributor